

LAKESIDE AT VALENTINE

STANDARD DETAILS

TYPICAL SCALE FOR DRAWINGS
SITE PLAN
FOUNDATION, FLOOR PLANS, FRAMING, ELEVATIONS, ELECTRICAL
SECTIONS AND DETAILS
INTERIOR ELEVATIONS

1" = 20'-0"
1/4" = 1'-0"
3/4" = 1'-0"
3/8" = 1'-0"

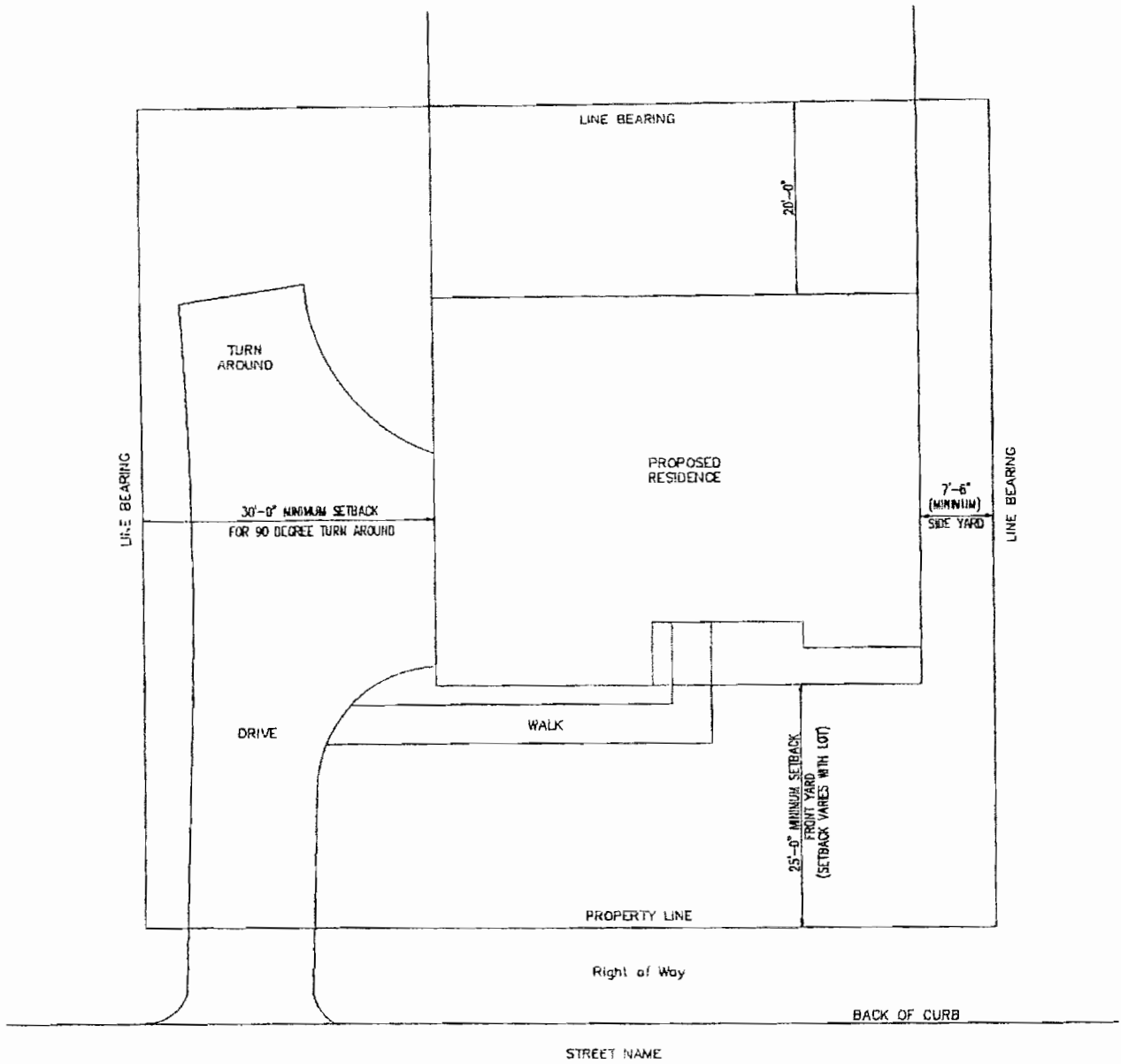

*SITE PLAN WITH
MINIMUM SETBACKS
NO SCALE*

—RIDGE LINE' RIDGE VENT WITH SHINGLE APPLICATION (TYPICAL)

9
MINIMUM
12

NOTE: COMPOUND ROOFS ALLOWED:
MAXIMUM OF TWO DIFFERENT ROOF
PITCHES ALLOWED

—SHINGLES—

1'-0"

3 5/8" CROWN MLD.
1X6 FRIEZE BD.
3 5/8" CROWN MLD.
1X10 FRIEZE BD.

MINIMUM CORNICE

DETAIL AT HIP ROOF
(PITCH, CORNICE, OVERHANG, ETC.)

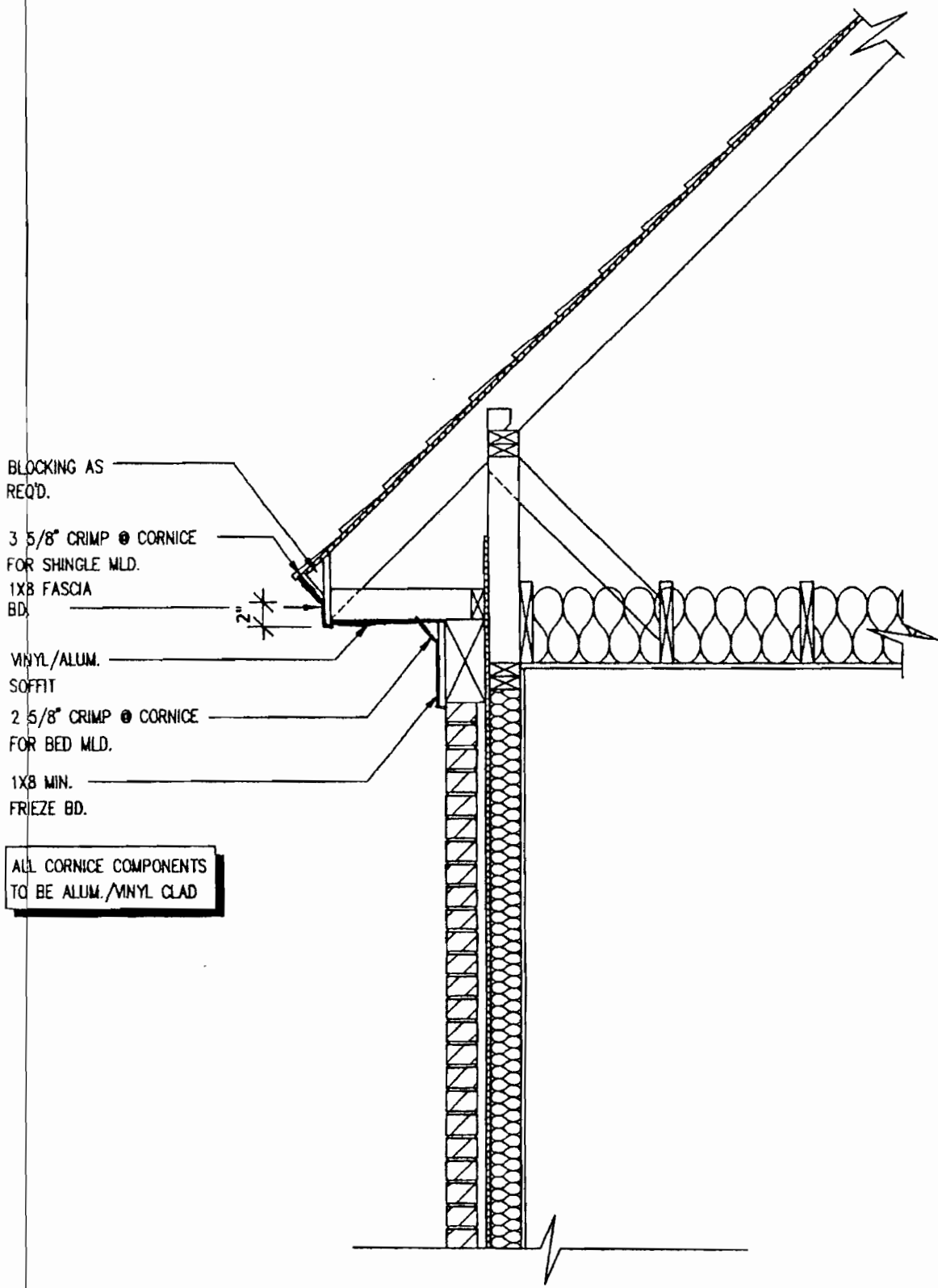

VINYL/ALUMINUM CORNICE DETAIL

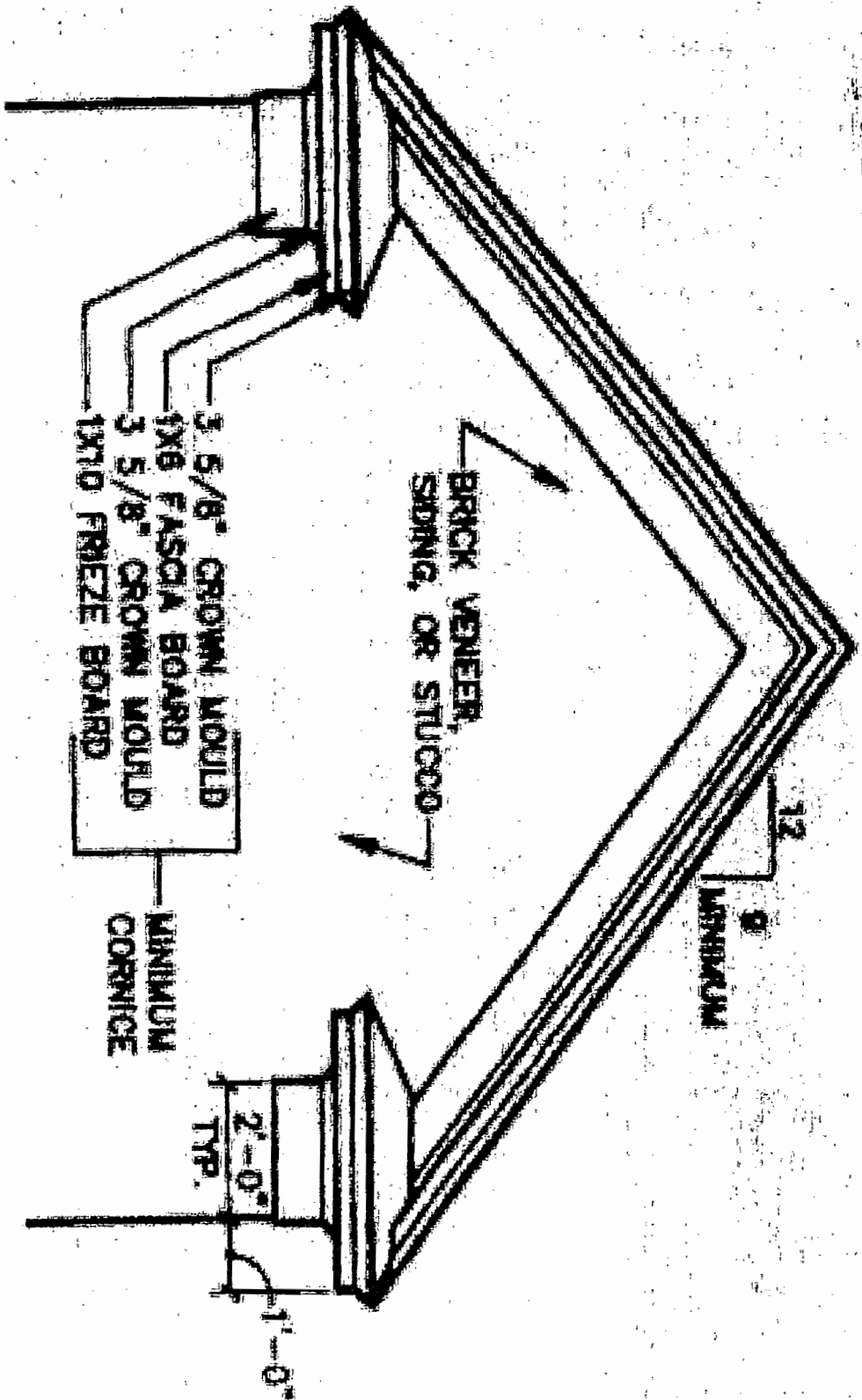

DETAIL AT GABLE ROOF

(PITCH, CORNICIE, OVERHANG, ETC.)

FLUE REVEAL
CONCRETE WASH



CHIMNEY

1" CORBELS
TYPICAL

NEAREST
ROOF
SURFACE

CHIMNEY DETAIL AT GABLE ROOF

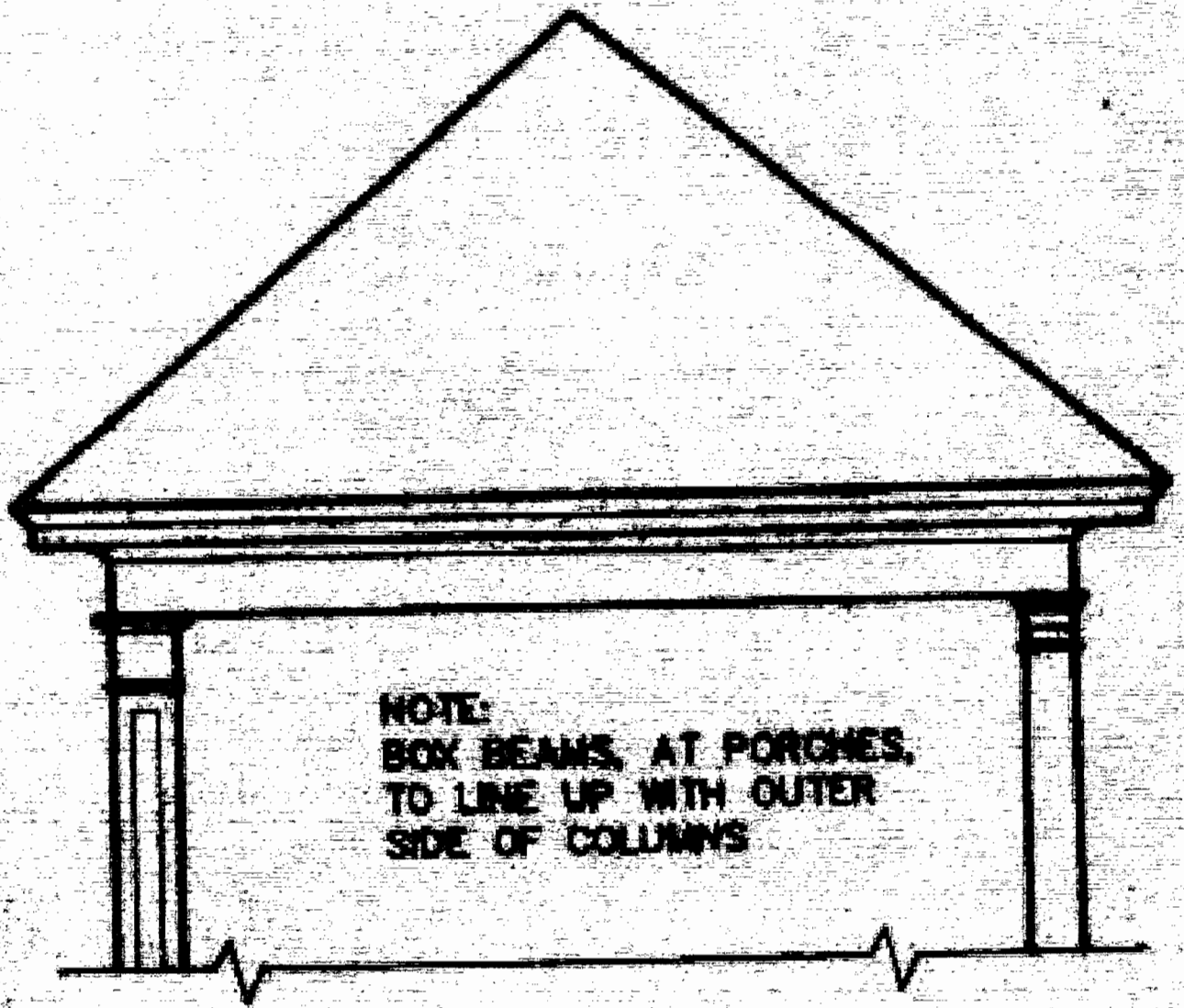

**NOTE:
BOX BEAMS, AT PORCHES,
TO LINE UP WITH OUTER
SIDE OF COLUMNS**

**COLUMN DETAIL AT PORCH
(COLUMN / BEAM RELEATIONSHIP)**

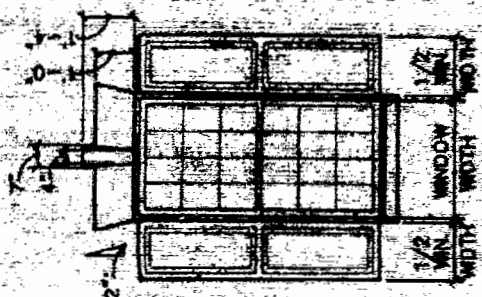
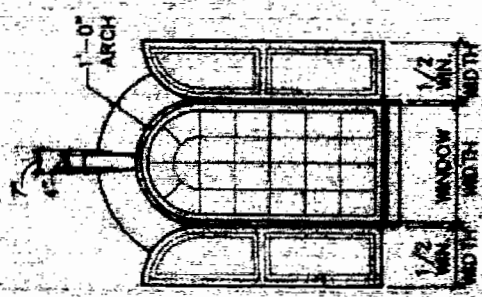
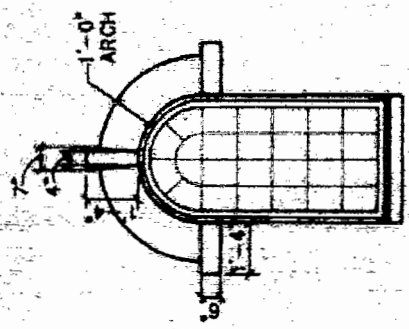
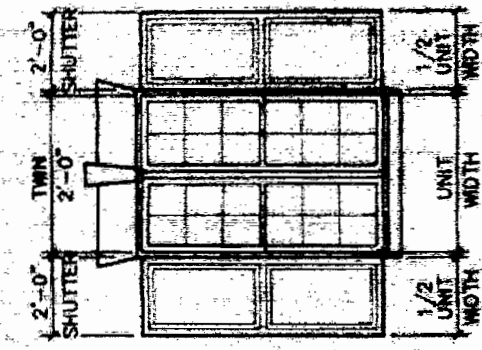

67 1/2"

JACKARCH / SHUTTER DETAILS

NOTE:
NO SHUTTERS ON TRIPLE WINDOW UNITS

FIRE REVEAL
CONCRETE WASH

1" CORBELS
TYPICAL

CHIMNEY

3'-0"
MINIMUM

10'-0"
MINIMUM

CRICKET

NEAREST
ROOF
SURFACE

CHIMNEY DETAIL AT HIP ROOF

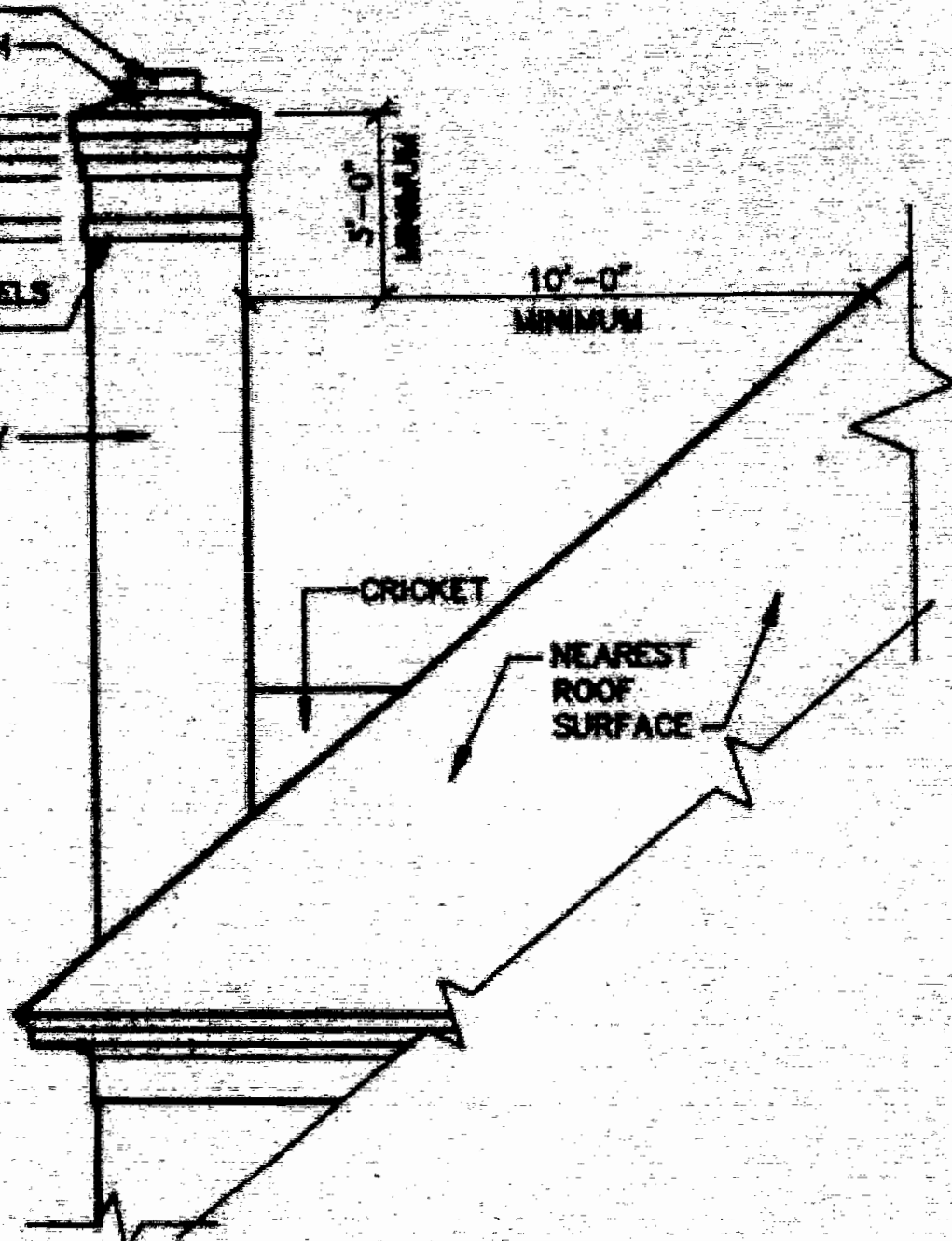

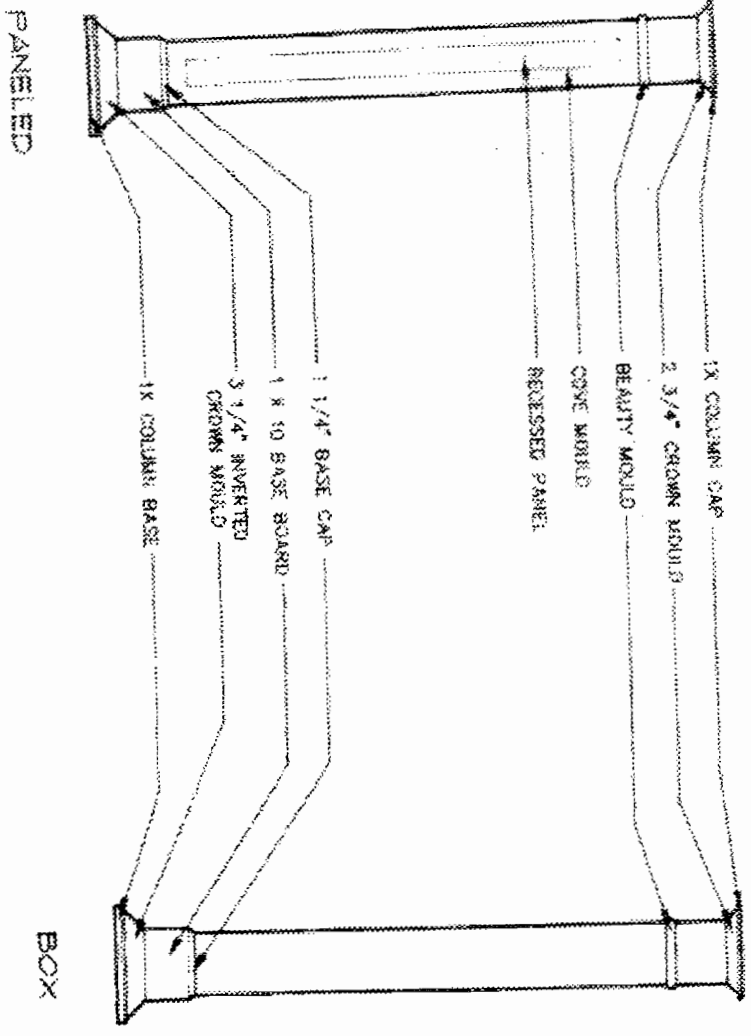

PANELED

BOX

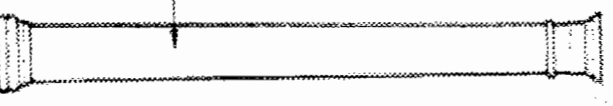

ROUND

COLUMN DETAILS

10" DIAMETER
TAPERED WOOD
COLUMN WITH
IONIC CAPITAL
AS PER
"MORTENSTEN
GROUP LTD."
OR EQUAL

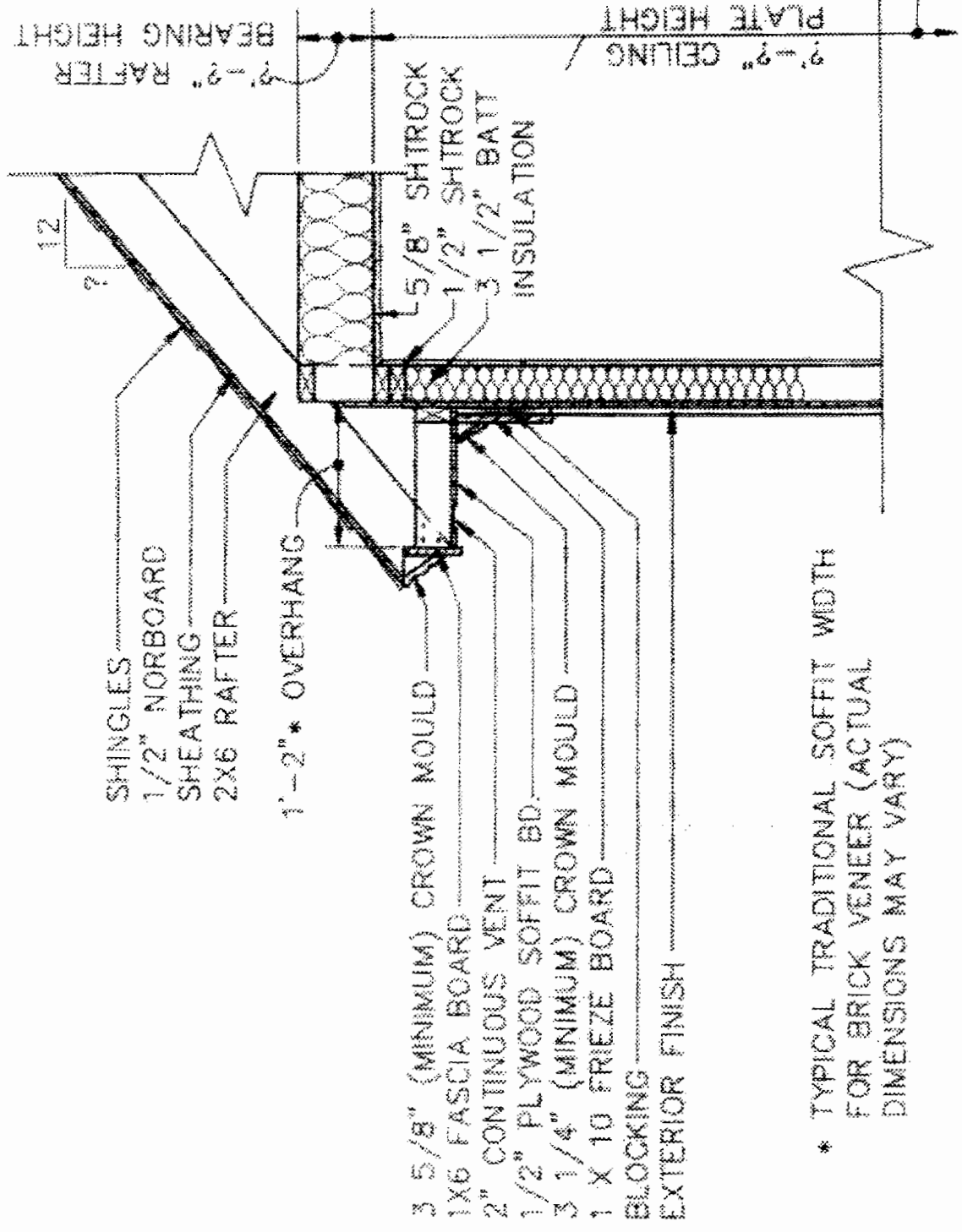

SHINGLES
 1/2" NORBOARD
 SHEATHING
 2X6 RAFTER
 1'-2" * OVERHANG
 12
 ?
 2'-2" RAFTER BEARING HEIGHT
 2'-2" CEILING PLATE HEIGHT
 TO LINE OF FIRST FLOOR

5/8" SHROCK
 1/2" SHROCK
 3 1/2" BATT INSULATION

3 5/8" (MINIMUM) CROWN MOULD
 1X6 FASCIA BOARD
 2" CONTINUOUS VENT
 1/2" PLYWOOD SOFFIT BD.
 3 1/4" (MINIMUM) CROWN MOULD
 1 X 10 FRIEZE BOARD
 BLOCKING
 EXTERIOR FINISH

* TYPICAL TRADITIONAL SOFFIT WIDTH FOR BRICK VENEER (ACTUAL DIMENSIONS MAY VARY)